



Routine Cleaning Procedures Lemur

PAPER GUIDE SLIDER BAR

Confirm that the slider bar on the paper path is properly adjusted for the width stock being used. If the slider bar is adjusted too far away from the ticket it may cause crooked printout or the printer to skip tickets.

To adjust the paper path for use with a different ticket width, adjust the slider bar to the fully open position. Insert your ticket stock into the paper guide. Adjust the slider bar down to the proper ticket width, making sure the bar is not too tight against the ticket. The ticket should move freely in the paper guide.

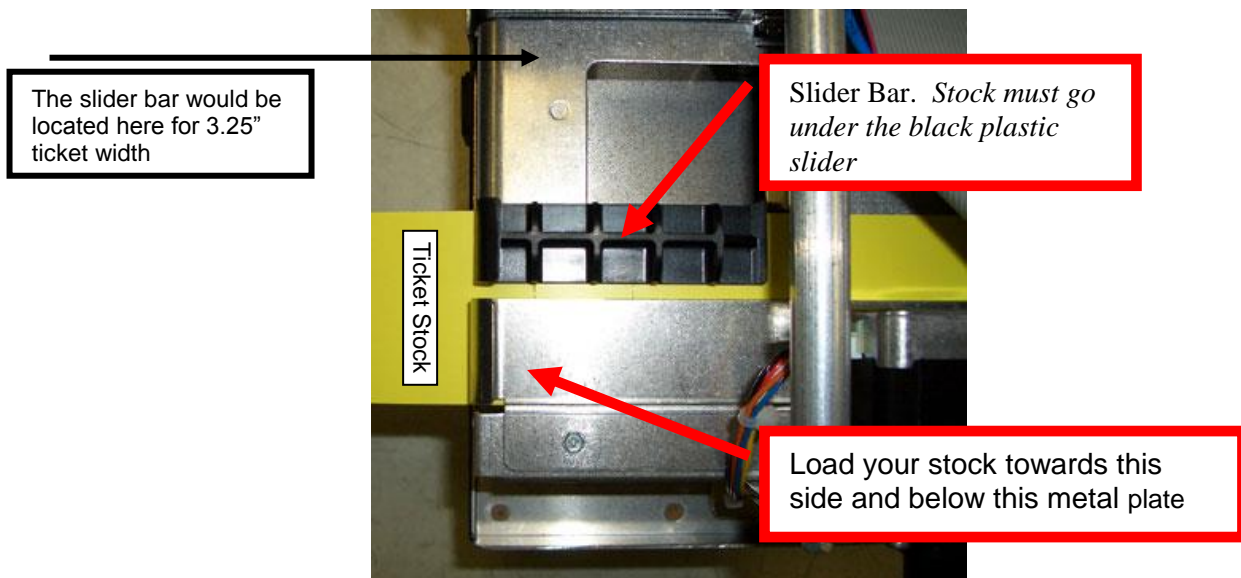

Above photo is of a RDJW paper path set for 2" wide stock

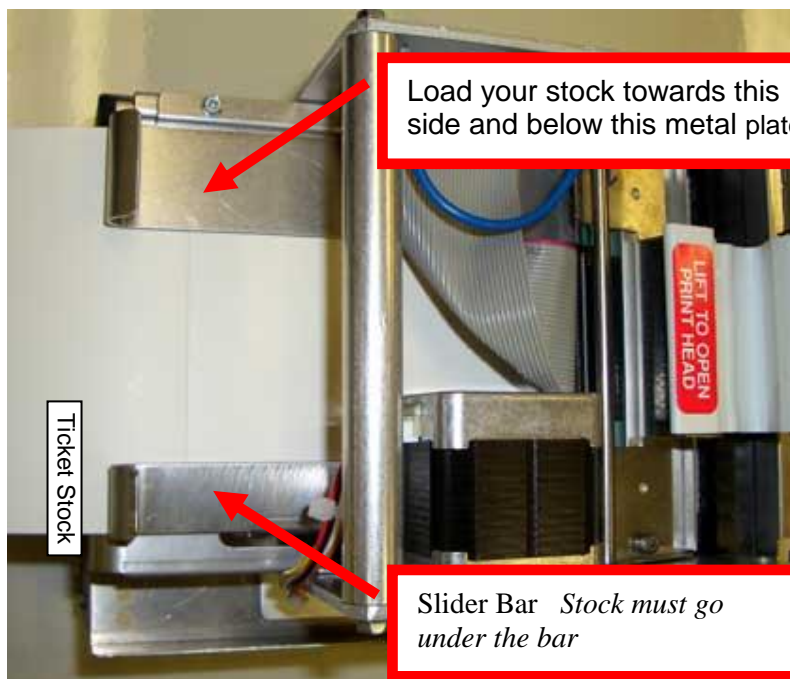

Above photo is of ADJ paper path set for 4" wide stock

THERMAL PRINT HEAD CLEANING PROCEDURE

The print head should be cleaned periodically to prevent debris from building up on the print element. The required cleaning interval varies greatly depending on the quality of the ticket stock and the amount of dust entering the print area. Excessive dirt build up on the print head will result in reduced quality. Continuing to run the print head in a dirty condition will reduce its life expectancy, as it is unable to diffuse its heat properly.

The following is done with the printer powered off and unplugged from the AC source.

The thermal print head can be removed for cleaning or replacement, as follows:

1. Make sure power is off and the AC cord is disconnected from the printer.
2. **DO NOT UNPLUG CABLE FROM PRINT HEAD.**
3. Lift up on the cam lock assembly (located above the head mounting plate) to remove pressure from the thermal head.

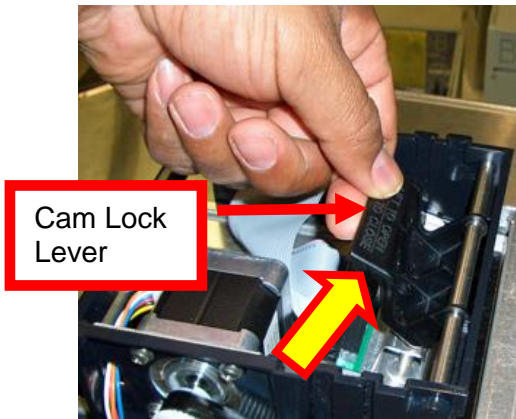

4. Position the cam lock level as far forward as possible.

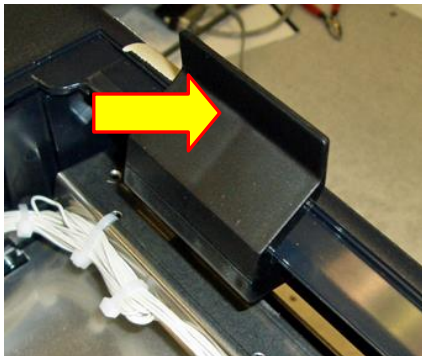

5. Flip the head back toward the rear of the printer. Denote what slot the print head was taken out of. Below photos show the different type of head mounting plates used through the production history of the Lemur series printers.

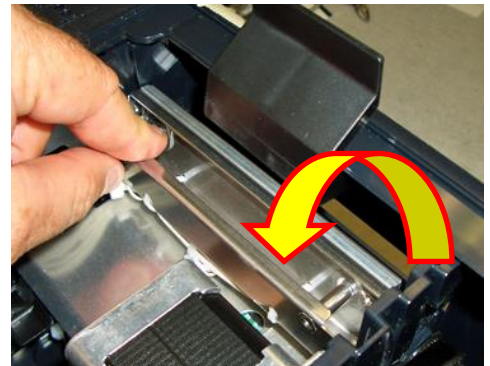
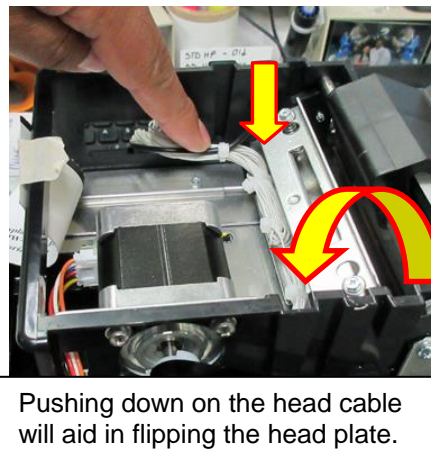
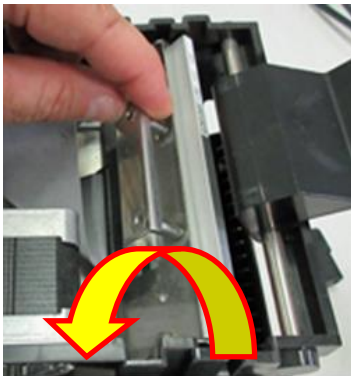

6. Lift the print head mounting plate straight out.

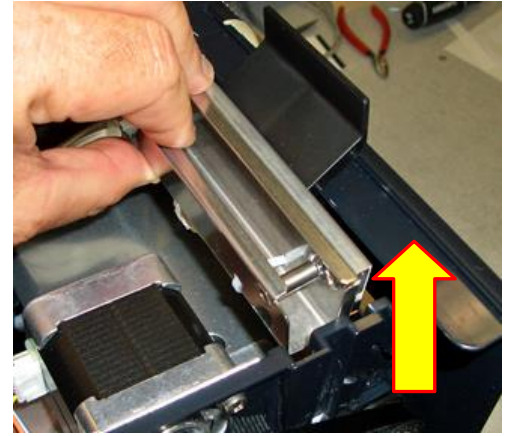
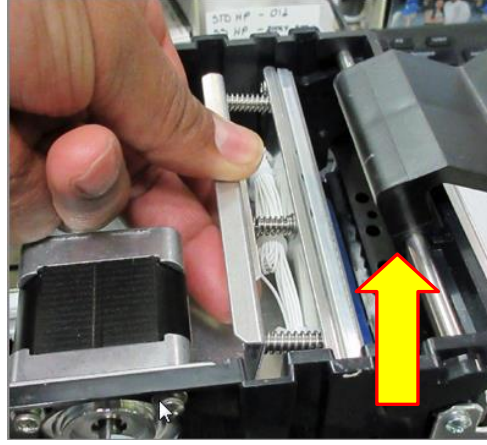
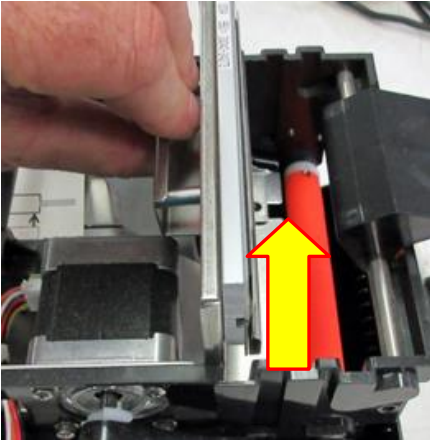

7. Clean the thermal print head surface (the side that makes contact with the paper) with isopropyl alcohol & paper towel.

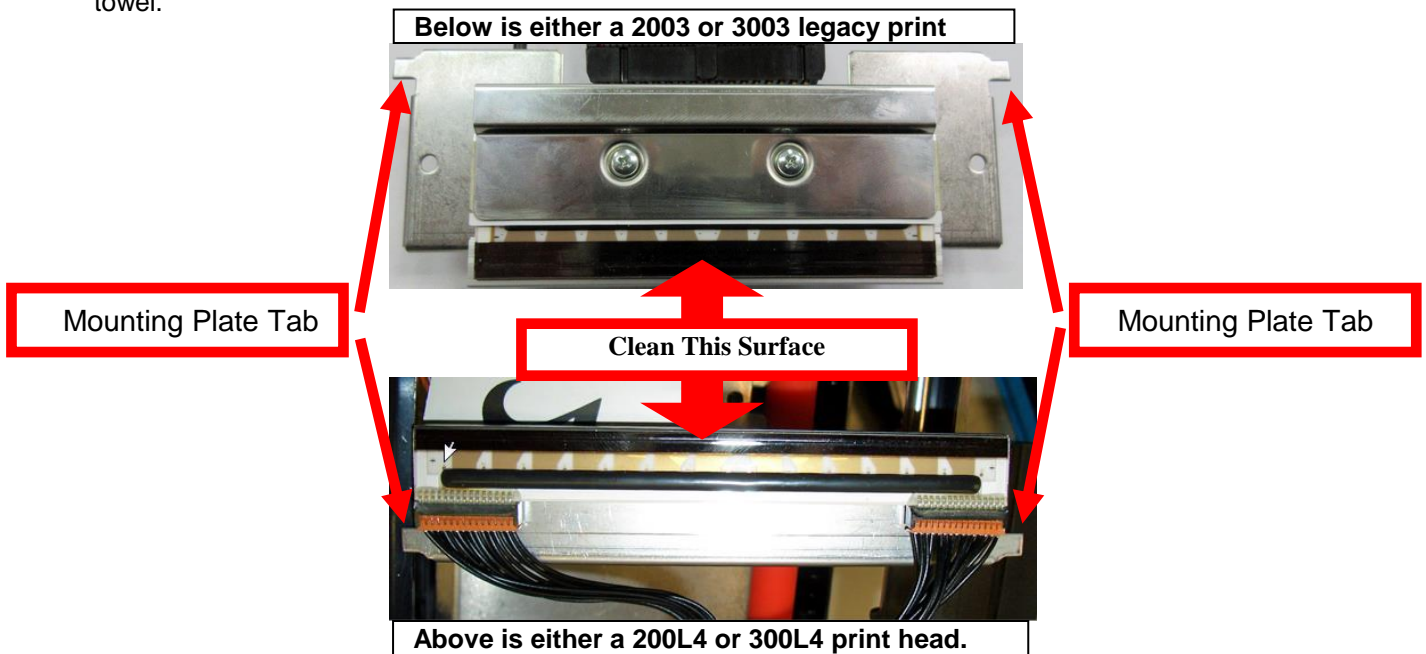

8. Install the head mounting plate by reversing the above procedures. Make sure the print head mounting plate tabs are in the correct print cage slots.

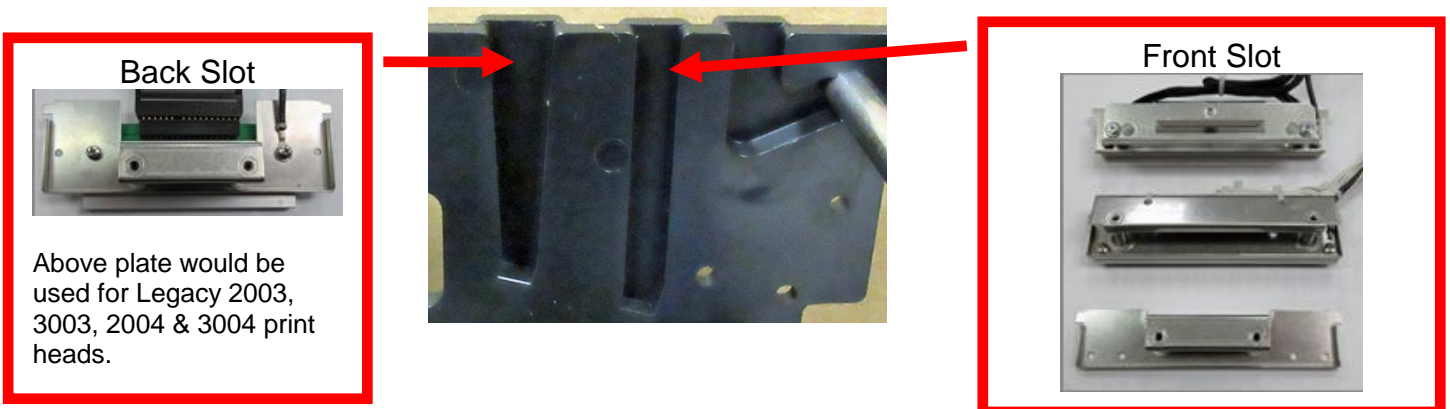

9. Restore pressure to the head by pushing down on the cam lock assembly. The printer is now ready for operation.

PLATEN CLEANING PROCEDURE

The Platen (rubber drive roller) should be cleaned once a year to prevent paper dust from building up on the roller. (NOTE: The platen may require more frequent cleaning in dusty environments or when using inferior ticket stock.)

1. With the print head still removed, clean the platen.
2. Apply a small amount of Isopropyl alcohol onto a paper towel to clean the rubber roller.
3. Clean only the part of the rubber roller where the ticket stock makes contact with.
4. Rotate the rubber roller clockwise a little and repeat step 4; continue in the same manner for one full revolution of the rubber roller.
5. Move onto cleaning the SQ load opto if the printer has one.

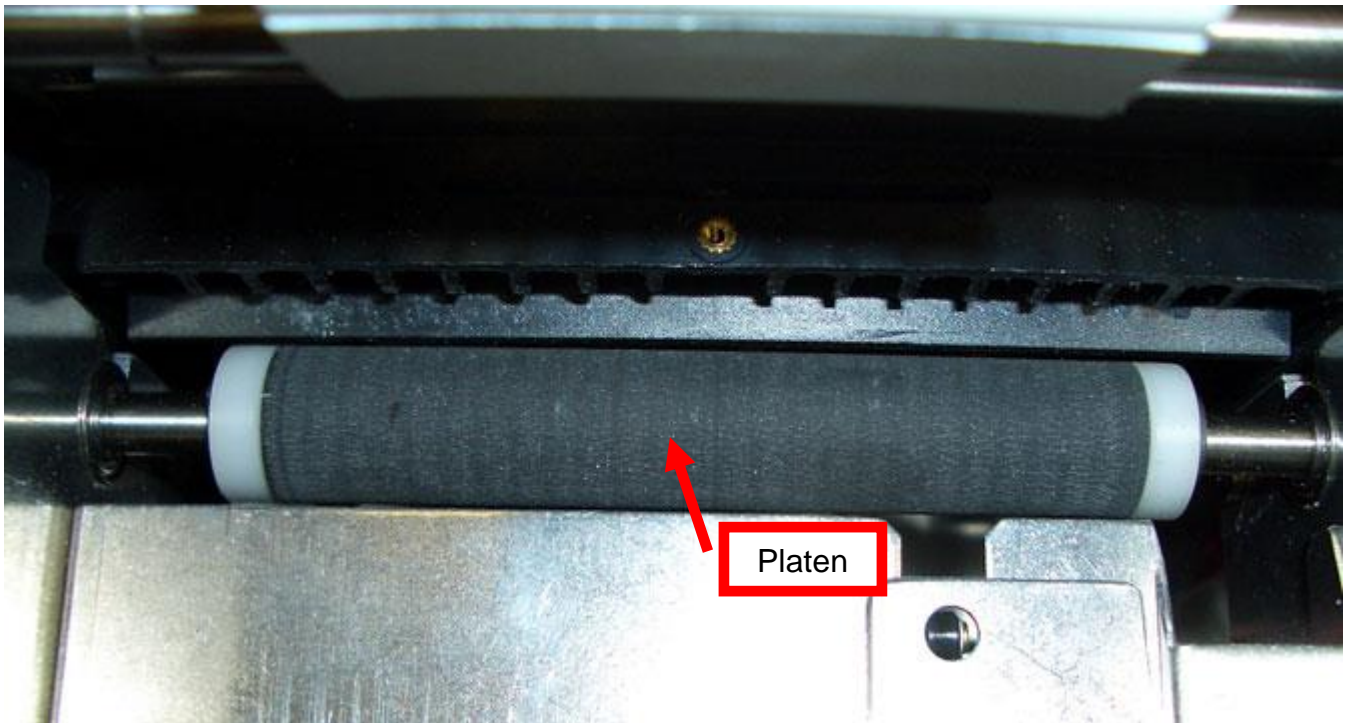

Platen size may vary from what is shown in the photo.

Clean SQ Load Opto if printer has one

A printer built after August 2014 may have a load SQ opto that is responsible for letting the printer know when it has paper stock loaded in the printer. Printers with s/n 310327 or higher.

1. Using inert dusting gas (canned air) or equivalent blow air over the opto eyes (see photo below).
2. Once the opto eye is cleaned, install the head by reversing the steps that was done [The Thermal Head Cleaning Procedure Section](#).
3. Restore pressure to the head by pushing down on the cam lock lever.

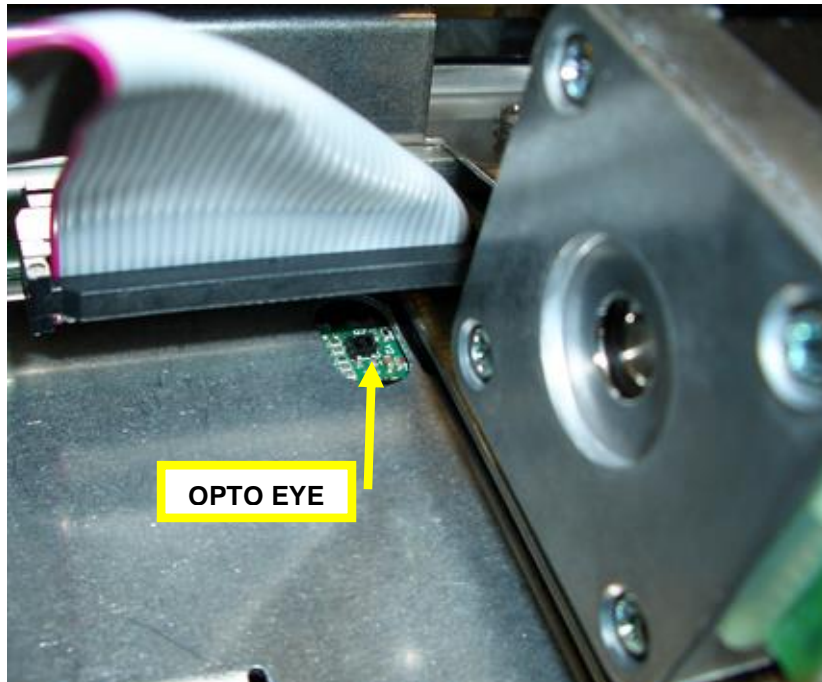

Above is a photo of a RADJW paper guide

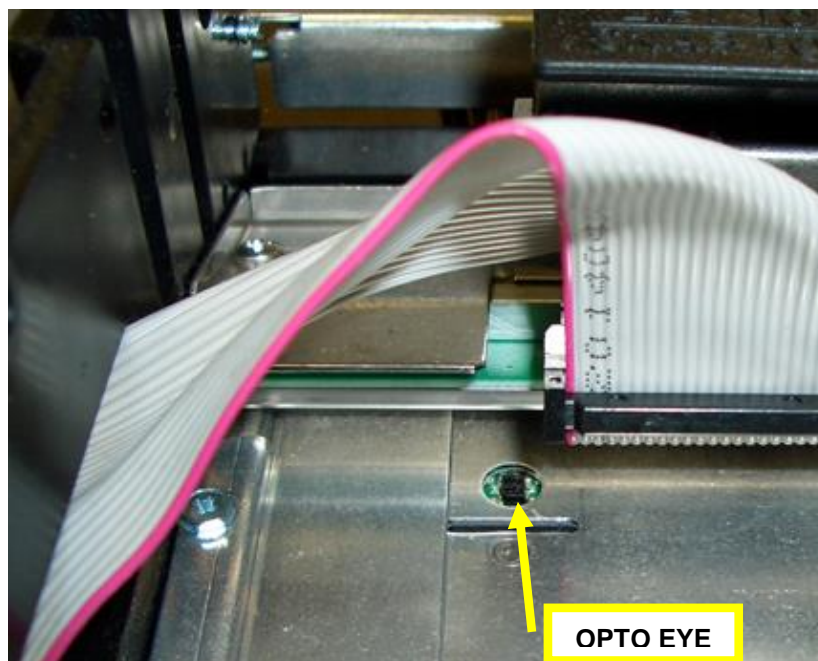

Above is a photo of a ADJ4 paper guide

OPTICAL DEVICES CLEANING PROCEDURE

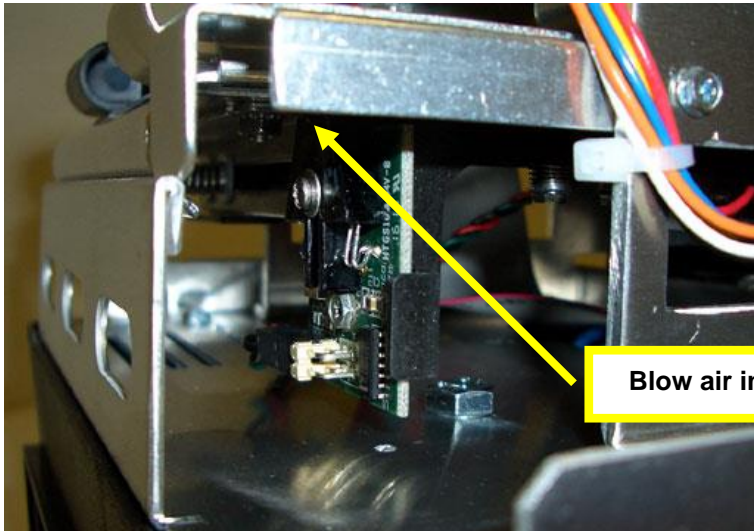

Above image is of a standard 422264 opto

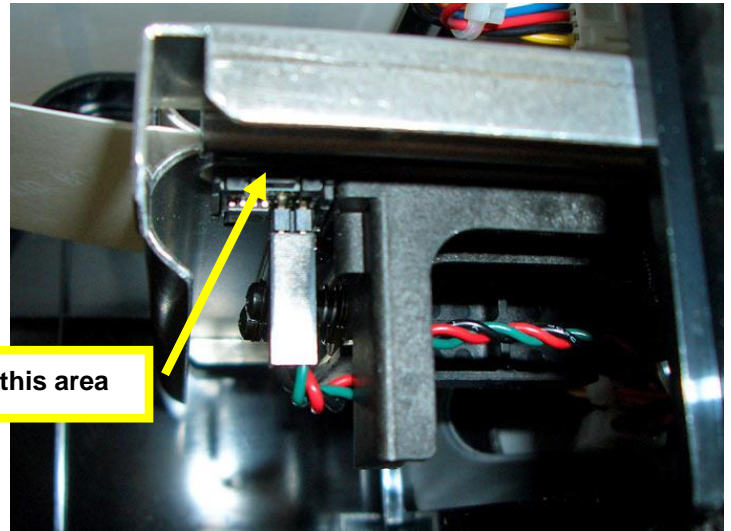

Above image is of a SQ opto

There is one optical device (opto) mounted on a black plastic bracket beneath the paper guide. The opto controls ticket cut/tear position. Over a period of time there may be an accumulation of ticket dust on the opto eyes themselves. This paper dust could cause erratic operation of the printer.

1. Using inert dusting gas (canned air) or equivalent blow air over the opto eyes (see above diagram).

The printer is now ready to be put back in service.

You may download the complete Lemur user manual via the below link.

www.bocasystems.com/documents/lemur_manual.pdf

rev 031017